

## What are they?



“**Small**” means that they are reactors with power equal to or below 300 MWe.

“**Modular**” means one single reactor that can be assembled with others to compose a nuclear power plant with greater power.

## Advantages and disadvantages

In comparison to reactors that produce greater power.

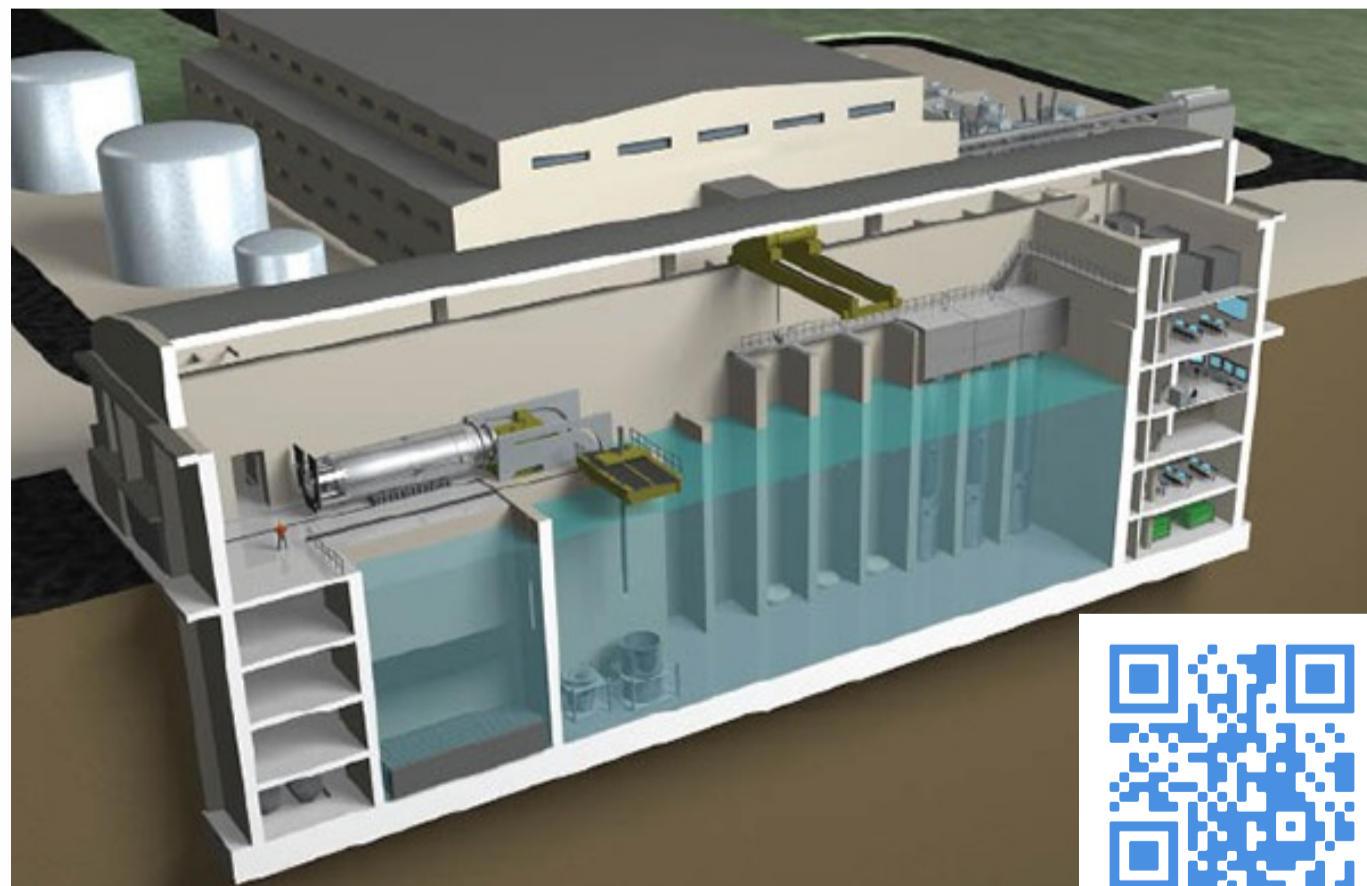

# Small Modular Reactors

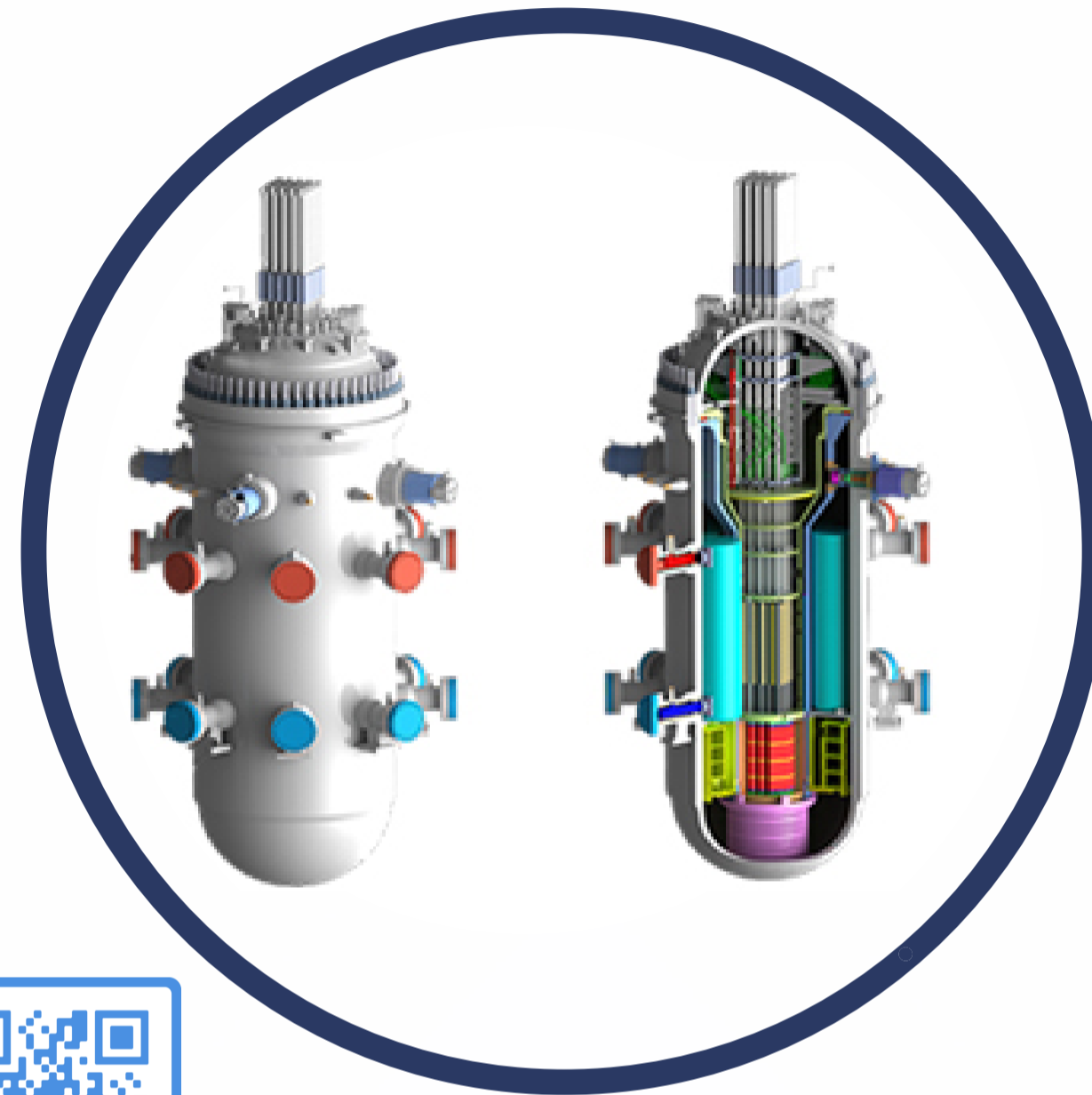

QUIZ

## Can they be an option for the future?

Yes, and it is already happening. Currently there are projects such as the CAREM reactor (in Argentina), already at an advanced stage of construction.



## Types of SMR

Currently there are over **50 SMR designs** at different stages of development.

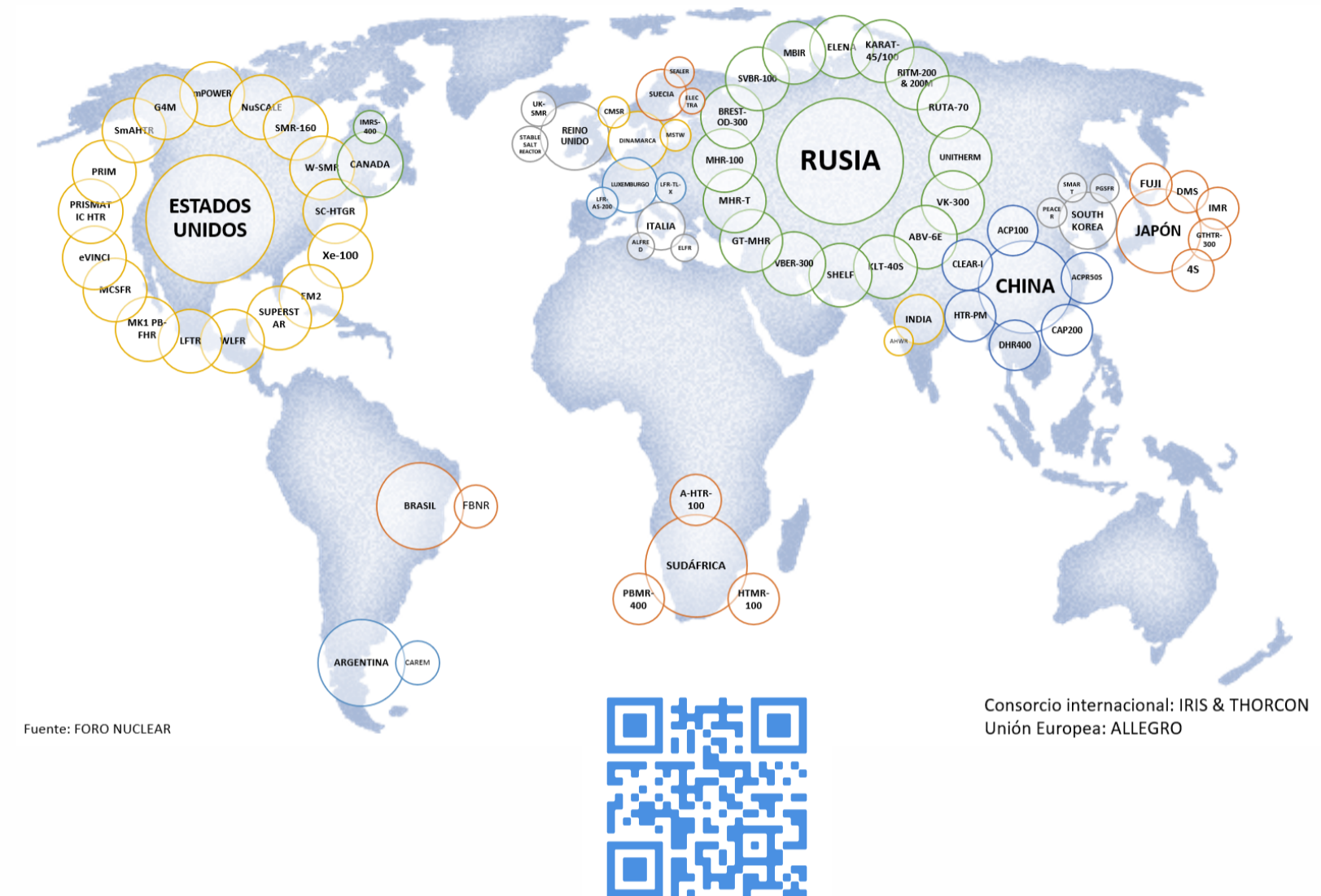

Fuente: FORO NUCLEAR

Consorcio internacional: IRIS & THORCON  
Unión Europea: ALLEGRO



## Other applications of SMRs



The main use of this technology is electricity production. There are, however, other applications that make the most of these reactors thermal capacities.

